

NOTES:
(MATCH WITH NUMBER IN CALL-OUT ON PRINT)

NBR: TEXT:

- 1 .030 ALUM. EXTERIOR W/CAP
- 2 DOUBLE REAR DOORS

- A 1-32" SIDE DOOR
- B 24" ATP STONEGUARD
- C 2-FLOW THRU SIDEWALL VENTS

DATE: 2/1/11 MODEL: ST716TA2 ORDER NUMBER: 000000 DEALER: BRAVO STOCK PG: 1 OF 1

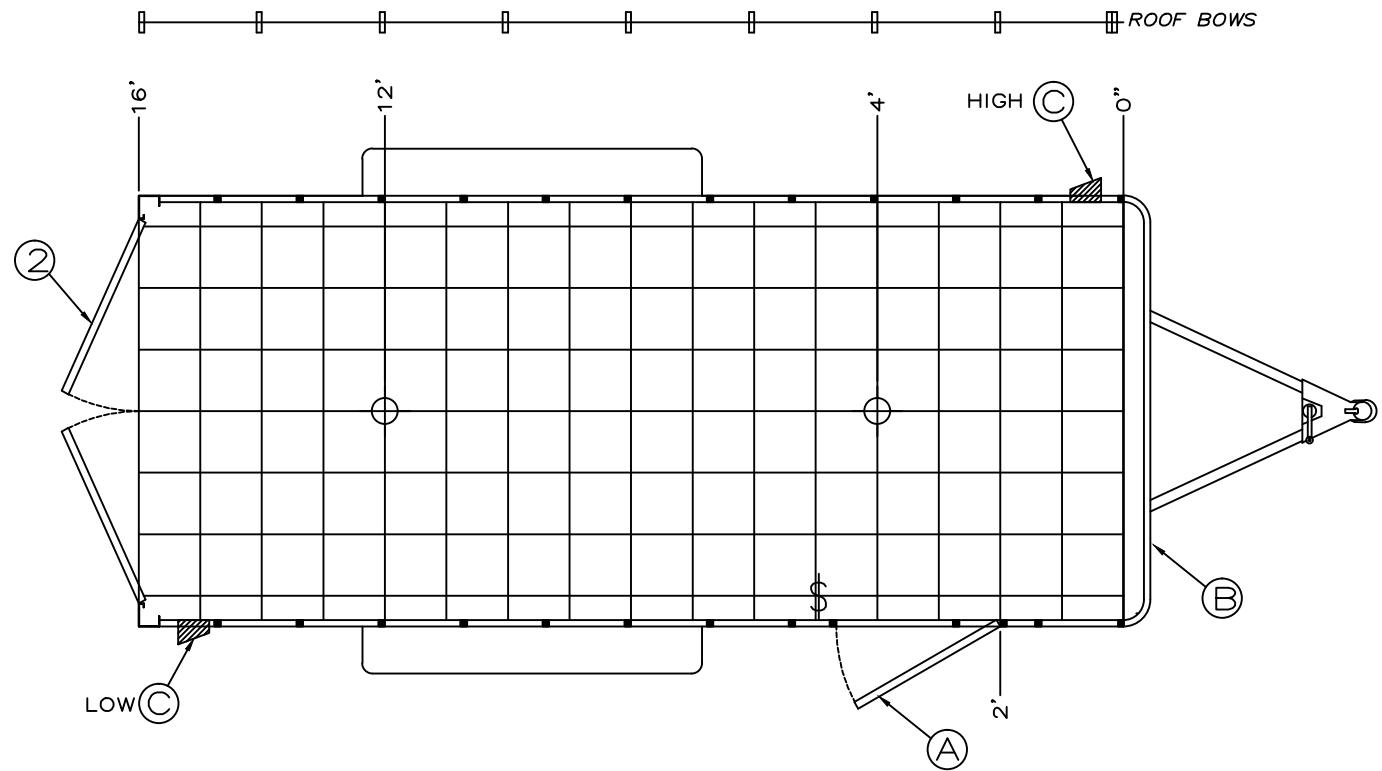

KEY:

- | | | | |
|--------------------------------|---------------------------|---|--------------------------------------|
| - 12v STANDARD DOME LIGHT | - DOUBLE TUBE FLUORESCENT | - ROOF VENT
(LABEL AS FOLLOWS:
N/P = NON POWERED
12v = 12 VOLT POWERED
110v = 110 VOLT POWERED
W/F = WIRE & FRAME FOR AIR
A/C = AIR CONDITIONER | - D-RING (FLOOR & WALL) |
| - 12v ICON STYLE DOME LIGHT | - SINGLE TUBE FLUORESCENT | - PANEL W/ LIFELINE
& CABLE HATCH
(LABEL W/AMPERAGE) | - E-TRACK
(FROM ARROW.. TO ARROW) |
| - 12v WALL SWITCH | - 110v WALL SWITCH | - MOTOR BASE PLUG
(LABEL W/AMPERAGE) | - ATP |
| - 12v WALL MOUNT LOADING LIGHT | - 110v WALL RECEPT | | |
| | - 110v GFI RECEPT | | |
| | - QUARTZ LIGHT | | |

APPROVED: _____

19319 COUNTY ROAD 8, BRISTOL IN 46507
PHONE: 574.848.7500 - FAX: 574.848.7550